

7



HAMMERS AND CHISELS

Hammers for mechanics 202

Special hammers 203

Sledge hammers 203

Mallets 204

Chisels 206

Cross cut chisels 207

Special chisels 207

Chisels for masons 208

Drift punches, pin punches and centre punches 209



HAMMERS AND CHISELS



382

UNI 7778 DIN 1041

Hammers for mechanics

- German model with flat square head and symmetric peen
- Forged Carbon steel head, subjected to a differentiated hardening treatment to prolong working life and to prevent chipping or mushrooming of the striking surface
- Enamelled finish with polished head and peen
- Ash wood handle

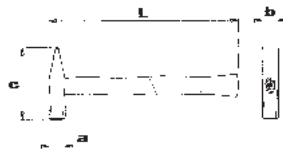

gr	a mm	b mm	c mm	L mm	gr
100	15	15	82	260	160
200	19	19	95	280	252
300	23	23	105	300	394
400	25	25	112	310	492
500	27	27	118	320	590
600	29	29	122	330	688
800	33	33	130	350	962
1000	36	36	135	360	1109
1500	42	42	145	380	1633
2000	47	47	155	400	2113



384

Hammers for mechanics

- French model with flat rectangular head and asymmetric peen
- Forged Carbon steel head, subjected to a differentiated hardening treatment to prolong working life and to prevent chipping or mushrooming of the striking surface
- Enamelled finish with polished head and peen
- Ash wood handle



a mm	b mm	c mm	d mm	L mm	gr
24	24	78	19	260	275
26	26	80	21	260	330
28	28	86	22	280	370
30	30	92	24	280	460
32	32	100	26	300	570
36	36	103	29	300	710
40	40	110	33	330	867
42	42	117	36	330	1050



382 MP

UNI 7778 DIN 1041

Hammers for mechanics

- German model with flat square head and symmetric peen
- Forged Carbon steel head, subjected to a differentiated hardening treatment to prolong working life and to prevent chipping or mushrooming of the striking surface
- Enamelled finish with polished head and peen
- Plastic handle



gr	a mm	b mm	c mm	L mm	gr
200	19	19	95	285	250
300	23	23	105	300	409
500	27	27	118	310	580
800	33	33	130	350	975
1000	36	36	135	355	1124



383 N

UNI 7779

Hammers for mechanics

- American model with flat round head and ball peen
- Forged Carbon steel head
- Enamelled finish with polished heads
- Hickory handle



gr	lbs	a ø mm	b ø mm	c mm	L mm	gr
340	¾	28,5	25	92	325	465
450	1	30	27	101	350	596
680	1 ½	35,5	32	121	400	967
910	2	38,5	35	126	400	1114

HAMMERS AND CHISELS



381 Hammer for hobbyists

- Model with flat round head and nail claw
- Forged Carbon steel head
- Enamelled finish with polished head
- Ash wood handle



gr	a mm	b mm	c mm	L mm	gr
300	24	25	97	300	330



379 Hammers for carpenters

UNI 10870

- Model with square head, nail slot and nail claw
- Forged Carbon steel head
- Enamelled finish with polished head
- Ash wood handle

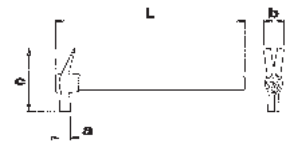

gr	a mm	b mm	c mm	L mm	gr
300	23,5	42	130	420	500
400	24,5	43	136	440	622



389 MG Hammer for upholsterers

- Model with one flat trapezoidal and one flat round head with magnet
- Carbon steel head
- Enamelled finish with polished heads
- Ash wood handle

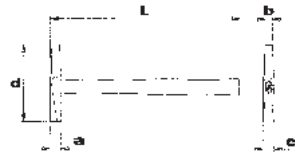

gr	a mm	b mm	c mm	d mm	L mm	gr
120	15	8,5	15	104	255	162



380 Sledge hammers

UNI 7777 DIN 6475

- Double-headed with square flat heads and chamfered edges
- Carbon steel head
- Enamelled finish with polished heads
- Ash wood handle

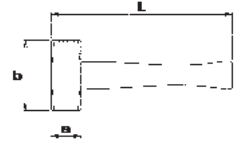

gr	a mm	b mm	L mm	gr
800	38	90	260	1003
1000	40	95	260	1123
1250	43	100	260	1400
1500	45	110	280	1711
2000	50	120	300	2250

Safety notice

- Select the most suitable hammer for the job.
- The striking surface of the hammer should be at least twice as large as the surface to be struck.
- Always check the condition of the hammer before use.
- Avoid using hammers with handles that are either damaged or not correctly attached to the head.
- Avoid using hammers with heads that show signs of wear, mushrooming or chipping
- Restore periodically the striking surface to its original state.
- Always strike with the center of the striking surface and never use on materials with a hardness greater than 47 HRC, to avoid chipping.
- Always use protective clothing and goggles.

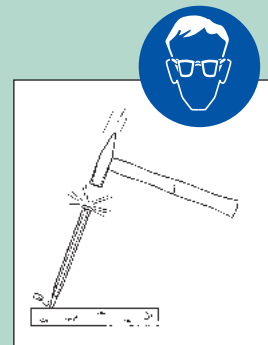

HAMMERS AND CHISELS



390

Copper sledge hammers

- Double-headed with square flat heads and chamfered edges and elastic safety pin
- Ash wood handle

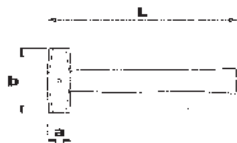

gr	a mm	b mm	L mm	gr
300	23	68	250	382
500	28	80	280	592
800	32	90	290	882
1000	35	100	300	1130



377

Mallet

- Model with combination striking surfaces steel and plastic
- Interchangeable tip
- Carbon steel head
- Enamelled finish with polished head
- Ash wood handle

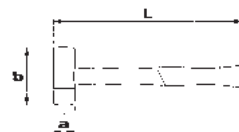

a ø mm	b mm	L mm	gr
35	95	310	582



374 N

Non-rebound mallets

- Model with interchangeable plastic tips
- Head partially filled with metal pellets to absorb rebound
- Carbon steel body
- Enamelled finish
- PVC handgrip



a ø mm	b mm	L mm	gr
35	116	310	754
40	125	315	881
50	133	325	1319
60	142	335	1752



376

Mallets

- Model with interchangeable plastic tips
- Carbon steel body
- Chrome plated finish
- Ash wood handle

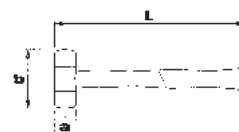

a ø mm	b mm	L mm	gr
22	74	250	145
28	88	275	204
35	97	300	440
42	108	325	630
50	112	350	932
60	128	380	1423

UNI 7784

374 NB

Spare pairs of plastic tips

a ø mm
35
40
50
60



376 B

Spare pairs of plastic tips

- For 376 (22÷60) and 377/35

a ø mm
22
28
35
42
50
60



HAMMERS AND CHISELS



378

Mallets

- Model with double rounded head in hard rubber
- Ash wood handle

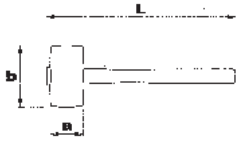

a ø mm	b mm	L mm	g gr
40	80	280	154
50	90	300	351
60	115	330	525
70	125	380	763



Spare handles

for hammers and mallets

376 E 22÷60 mm 376 (22÷60) and 377/35

381 A 381

382 E (100÷2000 gr) 382 (100÷2000 gr)

383 NA (340÷910 gr) 382 N (340÷910 gr)

384 A (24÷42 mm) 384 (24÷42 mm)



Spare handles for mallets

378 A (40÷70 mm)



Spare handles

for sledge hammers

380 A (800÷2000 gr) 380 (800÷2000 gr)



Spare handles for sledge hammers

390 A (300÷1000 gr)



Spare handles

for hammers

382 B (200÷1000 gr) 382 MP (200÷1000 gr)



Spare handles

for hammers

379 A (300-400 gr) 379 (300-400 gr)



HAMMERS AND CHISELS



351

UNI 7506

Ribbed chisels

- Forged Chrome Vanadium steel subjected to a differentiated hardening treatment to prolong cutting life and to prevent chipping or mushrooming of the striking tip
- Re grindable edge
- Zinc Chrome plated finish

L mm	a mm	b mm	g gr
125	18	10	103
150	21	12	164
175	14	13	266
200	26	14	330
250	29	16	520
300	32	18	813

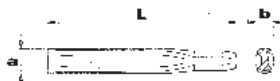

362

UNI 7504 DIN 6453

Chisels

- Forged Chrome Vanadium steel
- Re grindable edge
- Zinc Chrome plated finish

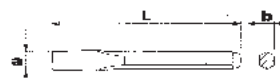

L mm	a mm	b mm	g gr
125	12	10	75
150	18	12	135
175	22	16	274



351 A

UNI 7506

Ribbed chisels with hand guard

- Forged Chrome Vanadium steel subjected to a differentiated hardening treatment to prolong cutting life and to prevent chipping or mushrooming of the striking tip
- Re grindable edge
- Zinc Chrome plated finish
- Protective hand guard in PVC

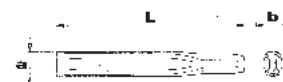

L mm	a mm	b mm	g gr
200	26	14	451
250	29	16	630
300	32	18	870

351 R Spare hand guard

L mm
200
250
300



HAMMERS AND CHISELS



364

UNI 7505 DIN 6451

Cross cut chisels

- Chrome Vanadium steel
- Re grindable edge
- Zinc Chrome plated finish



L mm	a mm	b mm	gr
125	4	10	70
150	6	12	118



353

Chisel with extra wide cutting edge

- Forged Chrome Manganese Silicon steel
- Re grindable edge
- Enamelled finish



L mm	a mm	b mm	c mm	gr
250	60	13	26	525

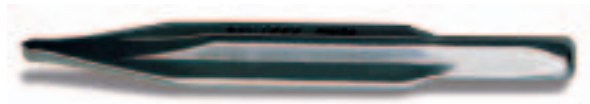

352

UNI 7507

Ribbed cross cut chisels

- Forged Chrome Vanadium steel
- Re grindable edge
- Zinc Chrome plated finish

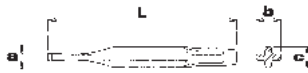

L mm	a mm	b mm	c mm	gr
150	6	20	16,5	131
200	8	24,5	20	298



353 A

Chisel with extra wide cutting edge and hand guard

- Forged Chrome Manganese Silicon steel
- Re grindable edge
- Enamelled finish
- Protective rubber hand guard



L mm	a mm	b mm	c mm	gr
250	60	13	26	605

353 R

Spare hand guard



www.usag-tools.com



Check the **online catalog** on the Usag web site. You will find instructions for use and technical information about USAG products.

HAMMERS AND CHISELS



354

Extra flat chisel

- Forged Chrome Vanadium steel
- Re grindable edge
- Enamelled finish

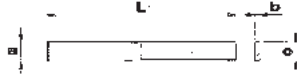

L mm	a mm	b mm	c mm	gr
235	26	7	26	234



359

Chisels for electricians

- Chrome Manganese Silicon steel
- Re grindable edge
- Enamelled finish

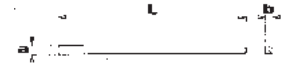

L mm	a mm	b mm	gr
200	10	8	93
250	10	8	116
200	14	10	141
250	14	10	179



354 A

Extra flat chisel with hand guard

- Forged Chrome Vanadium steel
- Re grindable edge
- Enamelled finish
- Protective rubber hand guard

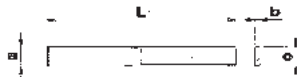

L mm	a mm	b mm	c mm	gr
235	26	7	26	335



360

Chisels for masons

- Forged Manganese Silicon steel
- Re grindable edge
- Enamelled finish

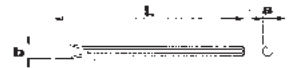

L mm	a mm	b mm	gr
300	16	22	474
400	18	26	810

354 R

Spare hand guard

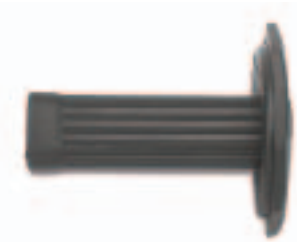

360 A

Chisels for masons with hand guard

- Forged Manganese Silicon steel
- Re grindable edge
- Enamelled finish
- Protective rubber hand guard

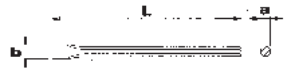

L mm	a mm	b mm	gr
300	16	22	570
400	18	26	885

HAMMERS AND CHISELS



361 Punches for masons

- Forged Manganese Silicon steel
- Re-grindable tip
- Enamelled finish



L mm	a mm	g gr
300	16	465
400	18	778



361 A Punches for masons with hand guard

- Forged Manganese Silicon steel
- Re-grindable tip
- Enamelled finish
- Protective rubber hand guard

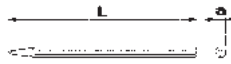

L mm	a mm	g gr
300	16	555
400	18	860

361 R Spare hand guard

- For punches 360 A and 361 A

axL mm
16x300
18x400



366 Drift punches

- Chrome Vanadium steel
- Zinc Chrome plated finish

UNI 7501 DIN 6458

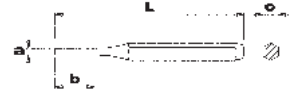

L mm	a mm	b mm	c mm	g gr
125	2	6	10	58
125	3	8	10	60
150	4	11	12	104
150	5	15	12	105
150	6	20	12	108



367 Pin punches

- Chrome Vanadium steel
- Inserted phosphatised tips for the 2 and 3 mm sizes
- Zinc Chrome plated finish

UNI 7502 DIN 6450

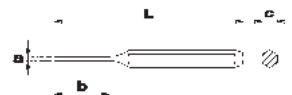

L mm	a mm	b mm	c mm	g gr
110	2	30	8	35
130	3	40	8	37
145	4	52	10	60
165	5	64	10	72
180	6	70	12	115
200	8	86	12	138
210	10	95	12	161

Safety notice

- Always check the condition of the tool before use.
- Avoid using tools with traces of wear, mushrooming or chipping.
- Always use protective clothing and goggles.



HAMMERS AND CHISELS



367 A

Pin punches with handle

- PVC cushioned handle
- Chrome Vanadium steel body
- Burnished finish

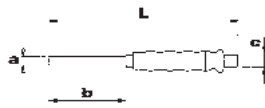

L mm	a mm	b mm	c mm	g gr
140	2	35	8	47
150	3	45	8	92
195	4	65	10	95
205	5	75	10	100
210	6	80	12	144
220	8	90	12	160
230	10	100	14	225

367 A/SE7

Set of seven pin punches

(367 A/2x175÷10x230 mm) g 900 gr

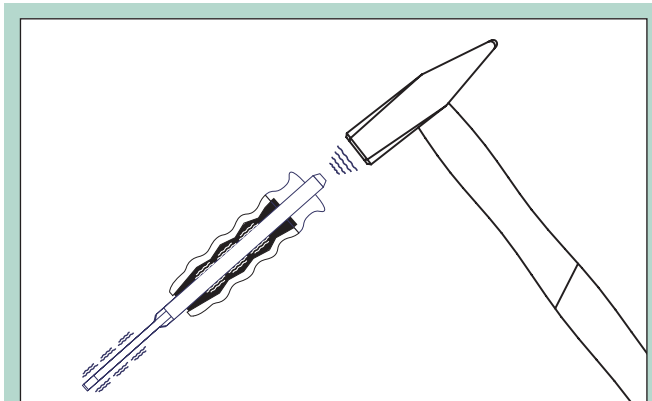

Ergonomics and safety

- Optimal grip due to the ergonomic anti-slip handgrip
- Completely absorbs vibrations due to its special softened elastic material
- High-resistance due to the quality of steel and heat treatments



368

UNI 7503 DIN 7250

Centre punches

- Chrome Vanadium steel
- Regrindable tip
- Zinc Chrome plated finish

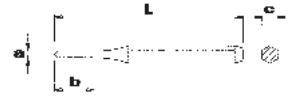

L mm	a mm	b mm	c mm	g gr
100	3	10	8	31
125	4	15	10	60
150	5	20	12	104



368 AN

Automatic centre punch

- Spring-loaded model, releasable by simple hand pressure
- Depth of cut controllable by rotating the head
- Regrindable tip
- Steel body
- Chrome plated and burnished finish

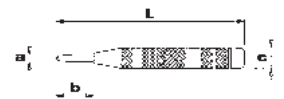

L mm	a mm	b mm	c mm	g gr
150	6	30	16	131

368 AC

Spare tip



HAMMERS AND CHISELS



367 SE6

Set of six pin punches

(367/2x110-3x130-4x145-5x165-6x180-8x200 mm)

– Supplied in plastic wallet 📦 510 gr

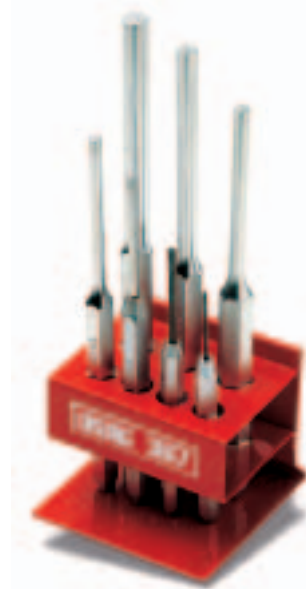

367 S7

Set of seven pin punches

(367/2x110-3x130-4x145-5x165-6x180-8x200-10x205 mm)

– Supplied with metal holder 📦 860 gr



372 SE6

Assortment in plastic wallet (6 pcs)

📦 550 gr

pcs	description	art./size
2	Chisels	362/125-150
1	Cross cut chisel	364/125
2	Drift punches	366/3x125-4x150
1	Centre punch	368/4x125



372 S7

Assortment with metal holder (7 pcs)

📦 820 gr

pcs	description	art./size
2	Chisels	362/125-150
2	Cross cut chisels	364/125-150
2	Drift punches	366/3x125-4x150
1	Centre punch	368/4x125

372 SV7

Empty holder

